

# PARK EVENTS

A choice of seven different Event Rooms to suit all requirements.  
The floor plans will give you an indication of the various rooms and their capacities.

## Festival Suite

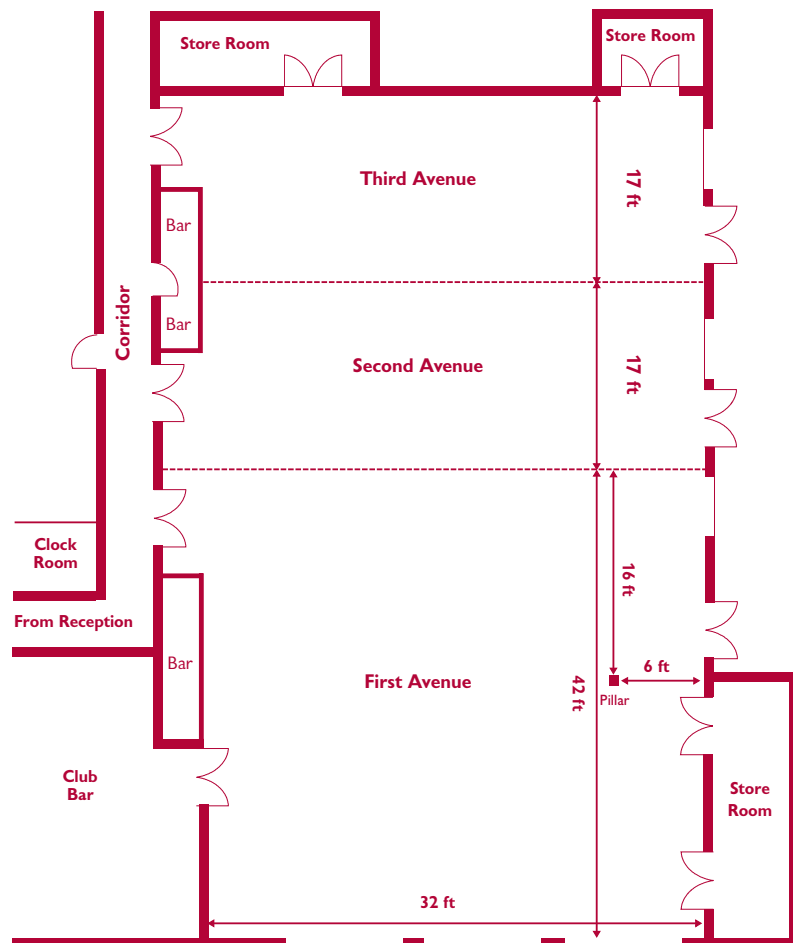

## Park Centre

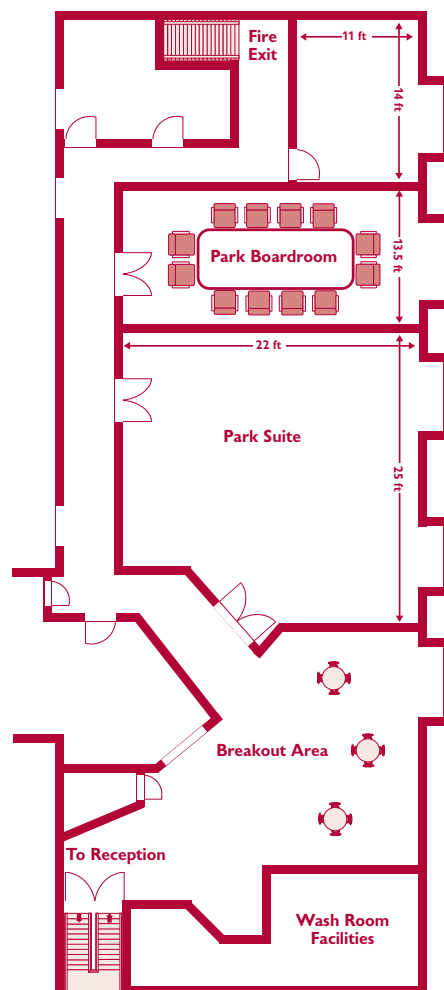

## EVENT ROOM SPECIFICATIONS

Maximum Capacities							Maximum Dimensions		
Suites	Theatre	Classroom	Boardroom	Cabaret	Banqueting	U-shape	Height (ft)	Length (ft)	Width (ft)
Festival Suite	220	110	-	90	150	-	9.55	76	32
First Avenue	100	130	40	42	85	40	9.55	42	32
Second Avenue	40	20	26	18	40	18	9.55	32	17
Third Avenue	40	20	26	18	40	18	9.55	32	17
Park Suite	35	16	18	-	-	16	7.1	25	22
Park Boardroom	-	-	12	-	-	-	7.1	22	13.5
Park Mews	-	4	-	-	-	-	7.1	14	11
Seasons Restaurant	-	-	-	40	70	-	7.9.9	38	34

## CONFERENCE & EVENTS SEATING ARRANGEMENTS

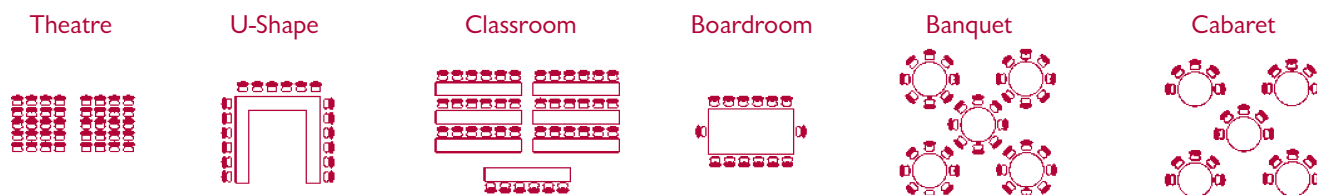

**Chichester Park Hotel**, Westhampnett, Chichester, West Sussex, PO19 7QL

Tel: 01243 786351, Fax: 01243 782371, Email: [info@chichesterparkhotel.com](mailto:info@chichesterparkhotel.com), Web: [www.chichesterparkhotel.com](http://www.chichesterparkhotel.com)